

WELCOME





Agenda

- Introductions 10 mins.
- Elections 10 mins.
- Budget for 2008 15 mins.
- Accomplishments 20 mins.
- 2008 Projects 20 mins
- Winter Plowing 10 mins.
- General Issues 20 mins.

Introductions

- President – Scott Boyle
- Vice President – Dan Heath
- Secretary - Suzanne Larsen
- Treasurer - Bob Burdette
- Area 1 – Scot Erickson
- Area 2 – Scott Clausen
- Area 3 – George Ramjoue
- Area 4 – Jennifer Kanzler
- Area 5 – Bruce Hutchinson
- Area 6 – Hutch Foster
- Area 7 – Robert Warnock
- Ranch Manager –

Elections

- President
 - Hutch Foster
- Treasurer
 - Bob Burdette
- Area 2 Representative
 - Scott Clausen
 - Jack Murphy
- Area 6 Representative
 - Duane Yamashiro
 - Michael Reason

Budget 2008

- 2008 Budget
- Impact fees
- Audit
- HOA fee increase
 - \$200.00 land
 - \$250.00 cabin
 - \$350.00 resident





Accomplishments

- Additional Paving of Tollgate Road
- Weed Control
- Mag-water treatment
- Gravel Pit
- Elk Road and Alexander Road
- Replacement of road signs
- Road Grading
- New Culverts
- Legal Issues
- Long Range Development Plan

2008 Projects

- Additional Mag-water treatment
- Additional road base for Elk/Alexander Road
- Road Work
- Tollgate Canyon Road
- Additional Replacement of road signs

CC&Rs

- CC&Rs – Covenants Conditions and Restrictions
- There for your protection
- Board needs to enforce the CC&Rs
- Board needs your help !
- ECC decisions :
 - Building Plans
 - Fences
 - Trailers
 - Dog runs, collars
 - Pets







Winter Plowing

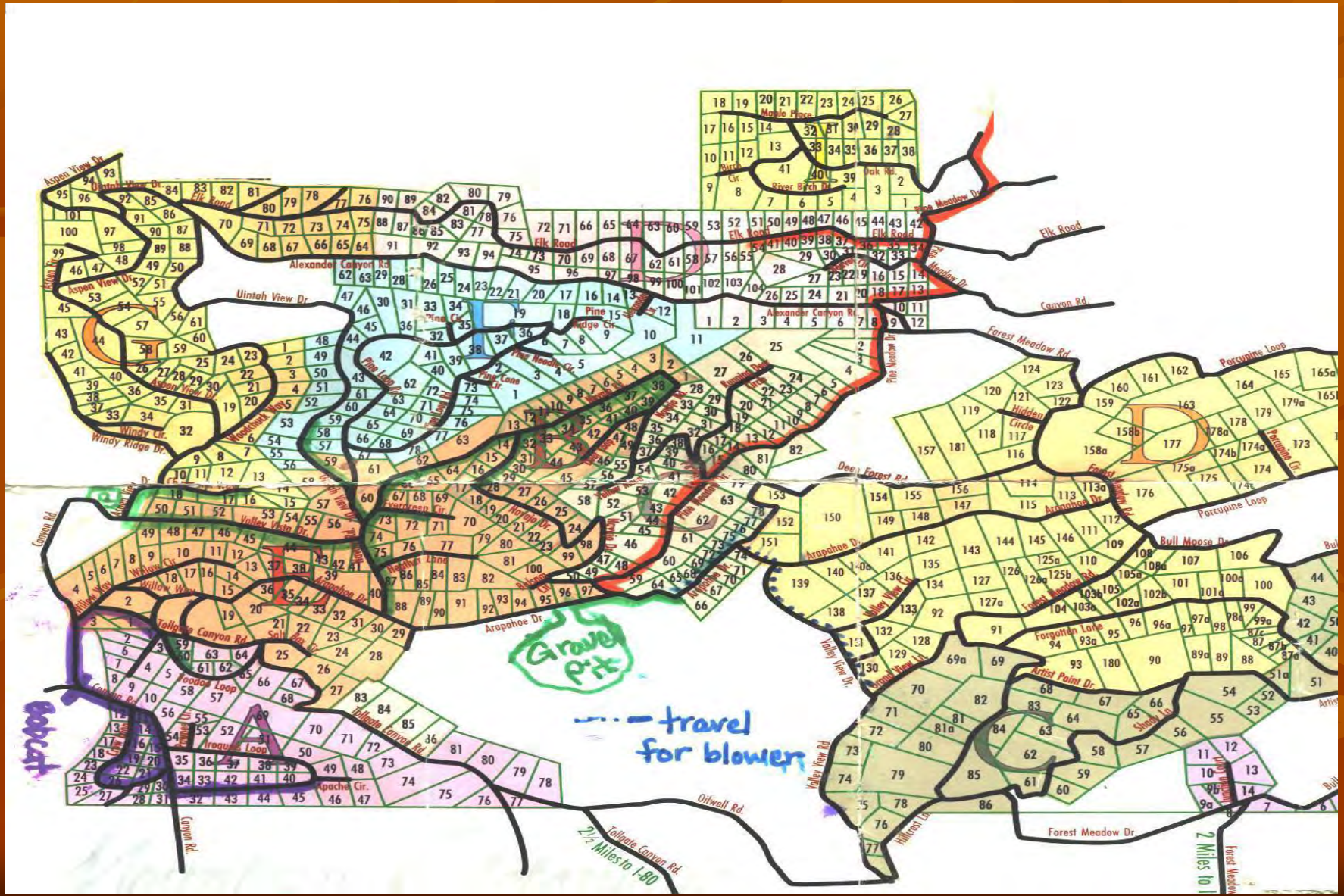

Winter Plowing

- Contract with the PMROA
- Insurance coverage for 1 million with PMROA named
- Roads, Power Boxes, Fire Hydrants, Culverts marked
- Snow removed/pushed to the ditches
- Tapered on one side and at the end of the route

General Issues

Q and A

- Trespassing
- ATV's
- Snowmobiling in lower Tollgate Canyon area
- Garbage clean-up
- Truck Traffic
- Deer Hunt Security
- Weed Control (County requirement)
- Lot numbers and Addresses
- Culverts

Lighting Strike



Thanks for Attending

The background of the slide is a solid orange-brown color. Overlaid on this background are several large, stylized leaves in various shades of brown and orange. The leaves have prominent veins and are arranged in a way that they appear to be floating or falling. The overall aesthetic is warm and autumnal.